

LOCATION PLAN

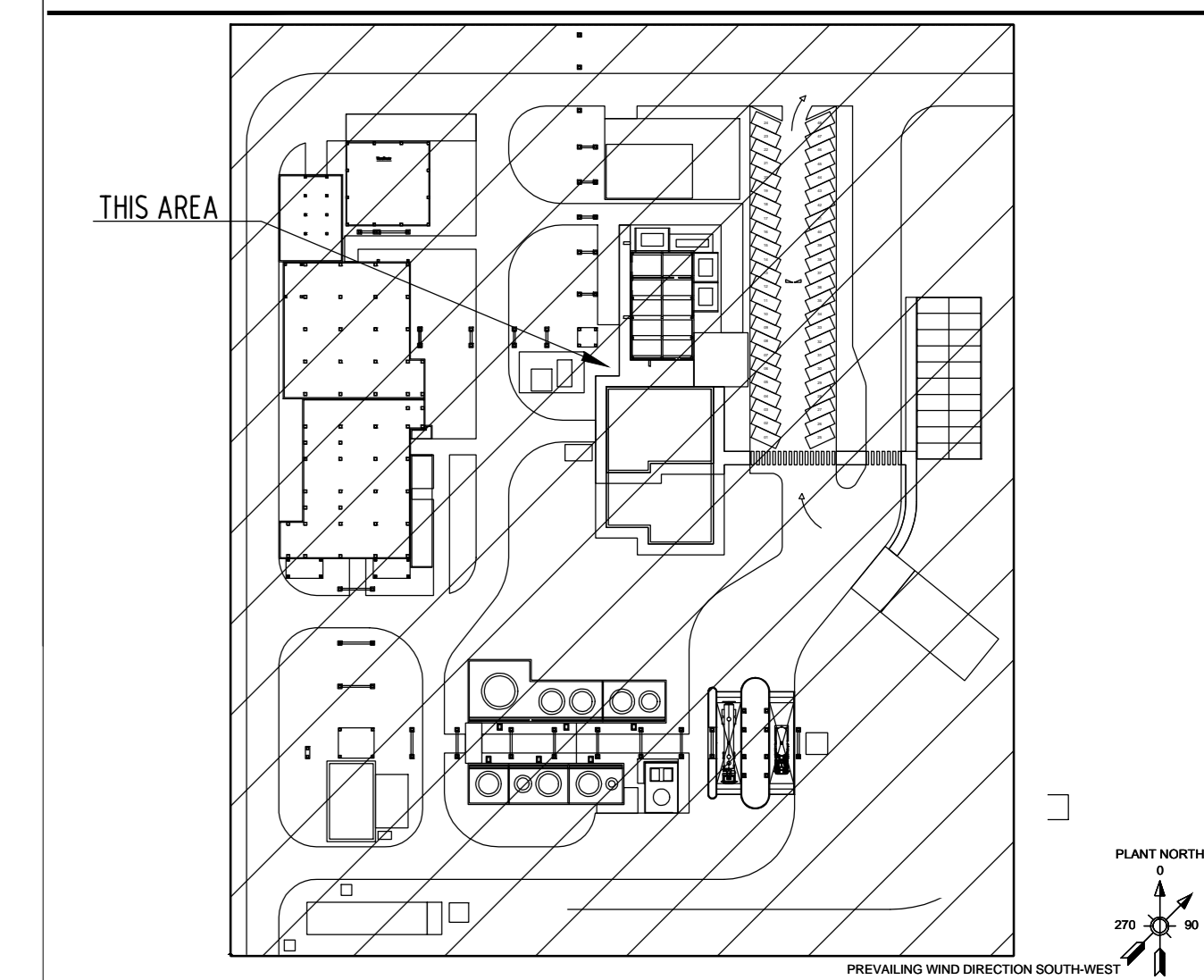

NOTES

1. SLOPE PIPES: MINIMUM 3mm/m (3‰)
2. MINIMUM GROUND COVER ON PIPES: 800mm
3. BY 3rd PARTY
4. EMERGENCY WEIR Ø300mm

GENERAL NOTES

1. X, Y, RD COORDINATES DUTCH SYSTEM
2. NORTH AND EAST PLANT COORDINATES AND LEVELS ARE IN M, WITH DECIMAL POINT
3. DIMENSIONS ARE IN MM
4. REFERENCE LEVEL: +100.000m = +1.70mNAP

LEGEND

- T.O.S. TOP OF STEEL
- H.P.P. HIGH POINT PAVING
- L.P.P. LOW POINT PAVING
- EL. ELEVATION
- W.W.T.P. WASTE WATER TREATMENT PLANT
- NA. NOT APPLICABLE
- TBC. TO BE CONFIRMED
- TBD. TO BE DETERMINED
- CWT. COOLING WATER TOWER
- RWP. RAIN WATER PIT 25m³
- OVS. OIL WATER SEPARATOR 135 (4x4.0 l/s)
- CP. COLLECTION PIT
- CP1. COLLECTION PIT 35 m³
- FFP. FIRST FLUSH PIT 45 m³
- SFP. SECONDARY FLUSH PIT 235 m³
- AG. ABOVE GROUND
- UG. UNDER GROUND
- SS. STAINLESS STEEL
- IL. INVERT LEVEL
- ◀. NORMALLY CLOSED VALVE
- ◻. NORMALLY OPEN VALVE
- ⬇. PUMP

- RAIN WATER
- RAIN WATER RECOVERED FROM ROOF
- DOMESTIC WATER + CWT BLOWDOWN + OFFGAS
- POTENTIALLY CONTAMINATED WATER
- PROCESS WATER

REFERENCES

- 05-BB001500/C.01a/0002 PLANT COORDINATES SYSTEM
- 05-BB001500/C.05a/0001 Battery Limits GSP/ARP - Coordinates Transformations
- 05-BB001500/C.05a/0010 Battery Limits ARP / GSP & Others
- 05-BB001500/G.02a/4000_2 Sewer Flowchart

No.	Date	Issue / Description	Issue	Checked by	Approved by
1	15/09/20	Issue for detailed		HdF	
		For Comments		WdF	DeJ



This drawing and its content remains the intellectual property of Worley Bergo BVBA, and/or its client. The drawing shall at no time be copied, shown to third parties, or used for any purpose other than that for which it was specifically provided.

Avantium
Delfzijl, The Netherlands
ARP Project Mondego - General

Sewer Location Plan		Scale: 1/250	Sheet No.: 01	Sheet Total: 08
Drawing number: 05-BB001501/C.01a/0008		Revision: 1	Date: 15/09/20	

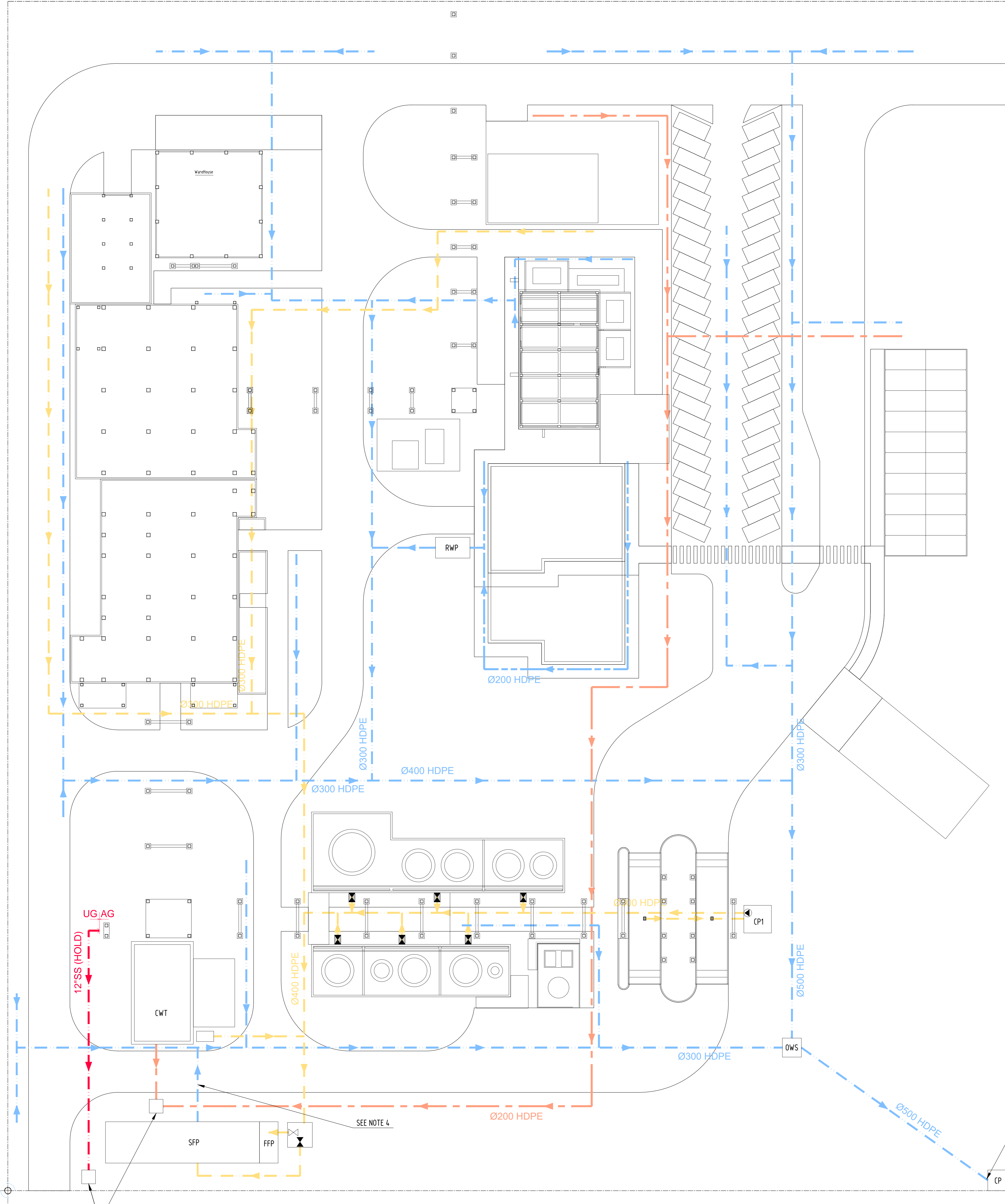

IL +98.000m (= -0.3mNAP)
DITCH ITO OOSTERHORN KANAALI
- WATER LEVEL -0.2m NAP

SEE NOTE 3

SEE NOTE 4

A
B
C
D
E
F
G
H
J
K

1 2 3 4 5 6 7 8 9 10 11 12 13 14 15

05-BB001500/C.01a/0008